

PRINTER (G108) POINT TO POINT DIAGRAM

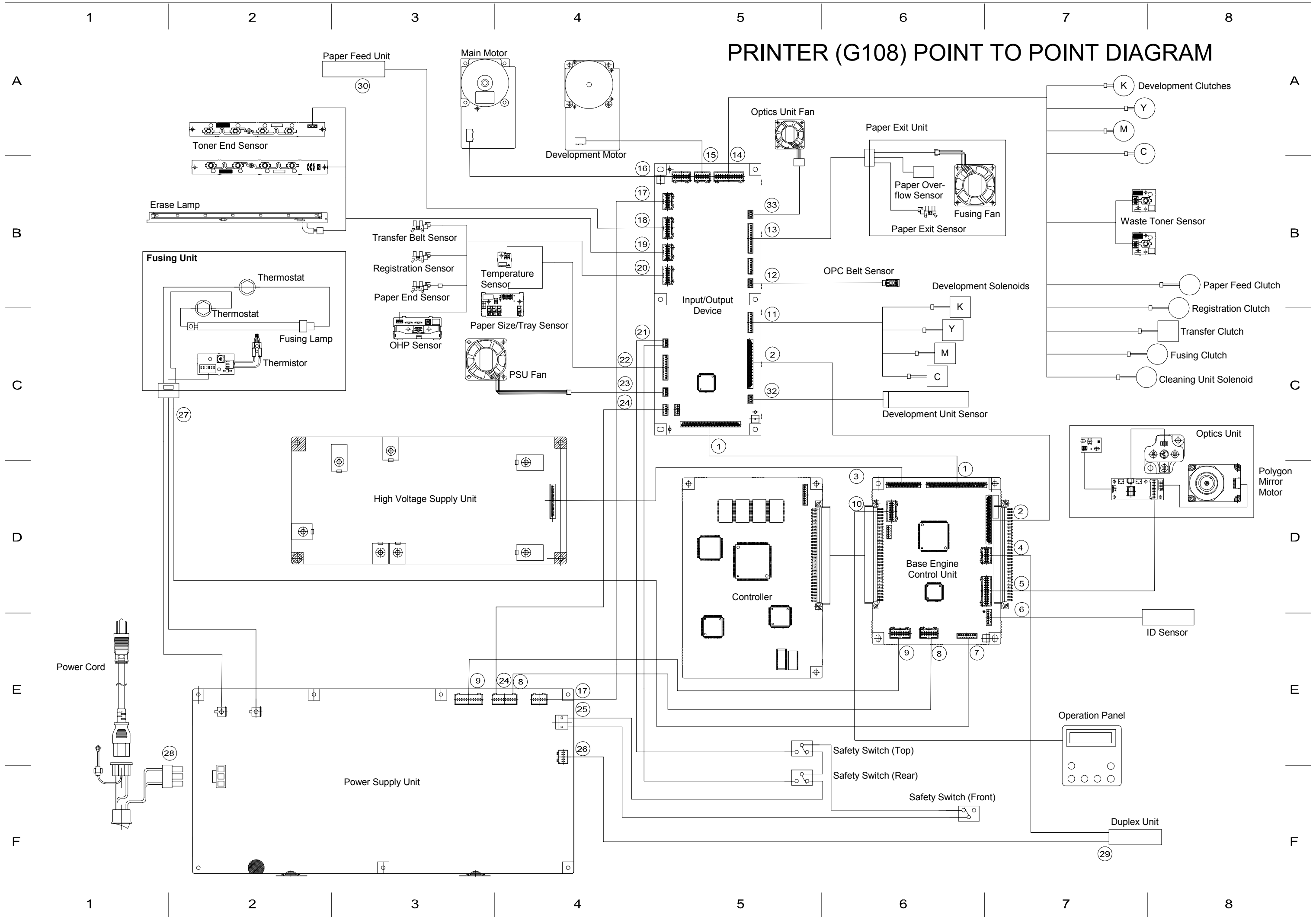

①

Pin No.	Signal Name	DCN1 Pin No.
39	SGND	1
38	+5V-S	2
37	I1RDWR	3
36	I1DATA	4
35	I1CK	5
34	I1LOAD	6
33	I1SCDO	7
32	I2C-CLK	8
31	I2C-DATA	9
30	DSL(K)ON-P	10
29	DSL(C)ON-P/FDCLL2ON-P	11
28	DSL(M)ON-P/FDCLL1ON-P	12
27	DSL(Y)ON-P/FDCLL2ON-P	13
26	TH3	14
25	IDATA	15
24	ILOAD	16
23	ISCK	17
22	SGND	18
21	LEDON-N	19
20	HTFANON-P	20
19	CTFANON-P	21
18	TBEN-N	22
17	PBSEN-N	23
16	ELON-P	24
15	PKCLL1ON-P	25
14	IOD1VOFF-P (+5V-SOFF-P)	26
13	OILLES-P	27
12	PWMSEND	28
11	BANKSEL	29
10	I/ODATA0	30
9	I/ODATA1	31
8	I/ODATA2	32
7	I/ODATA3	33
6	I/ODATA4	34
5	I/ODATA5	35
4	I/OAD0	36
3	I/OAD1	37
2	I/OAD2	38
1	SGND	39

②

Pin No.	Signal Name	DCN3 Pin No.
31	SGND	1
30	COLSEL1	2
29	COLSEL2	3
28	DCL(C)ON-P	4
27	DCL(M)ON-P	5
26	DCL(Y)ON-P	6
25	DCL(K)ON-P	7
24	PSL(KY)ON-P	8
23	PSL(MC)ON-P	9
22	SGND	10
21	MMCLK	11
20	MMON-N	12
19	MMREV-N	13
18	MMENC	14
17	MMGAIN	15
16	GARESET-N	16
15	RECLON-P	17
14	FBCLON-P	18
13	FBSLON-P	19
12	TRSLON-P	20
11	HTFANON-P/* OZFANON-P	21
10	FUCLON-P	22
9	PKCLU1ON-P	23
8	SGND	24
7	DMCLK	25
6	DMRDY-N	26
5	DMON-N	27
4	DMGAIN	28
3	TALWDDA	29
2	SEPASLON-P	30
1	SGND	31

③

Pin No.	Signal Name	CN1 Pin No.
21	PGND	1
20	PGND	2
19	PGND	3
18	+24V-1D	4
17	+24V-1D	5
16	+24V-1D	6
15	BRVON-N	7
14	CLVP-N	8
13	PWMON-N	9
12	BRVPWM-N	10
11	BRVERR	11
10	CBVPWM-N	12
9	THVON-N	13
8	DBV(MC)PWM-N	14
7	THVPWM-N	15
6	DBV(KY)PWM-N	16
5	THV-I	17
4	FCBPWM-N	18
3	BRVERR2	19
2	PGND	20
1	HVUCNCHK-N	21

④

Pin No.	Signal Name	Pin No.	Signal Name
1	D-COMMAND	2	DPCN-RET
3	DUMBUSY2-N	4	SGND
5	D-STATUS	6	SGND
7	DUPMON-P/D_SLK(+24VOFF-P)	8	SGND
9	DUREON-P/*DUPRES-N	10	DUPCHK-N
11	DPCN-CHK	12	SLEEP-P

⑤

Pin No.	Signal Name	Pin No.	Signal Name
1	+5V-1R	2	LCONT1
3	LREADY	4	LCONT2
5	SGND	6	LDREF4
7	VIDEO-N	8	LDREF3
9	VIDEO-P	10	LDREF2
11	SGND	12	LDREF1
13	BDT-P	14	LDREF0
15	BDT-N	16	+5V-1
17	SGND	18	SGND
19	SCMRDY-N	20	SCMCLK
21	PGND	22	SCMON-N
23	+24V-1	24	+3.3V

⑥

Pin No.	Signal Name
1	+5V-1
2	LED
3	SGND
4	Vo2:K
5	Vo1:YMC
6	NC

⑦

Pin No.	Signal Name
1	TH1
2	TH1
3	TH2
4	TH2
5	FUTEMP
6	SGND
7	TH4
8	TH5

⑧

Pin No.	Signal Name	Pin No.	Signal Name
1	TESYO1	2	TESTO2
3	TESTI1	4	TESTI2
5	+5VDO-N	6	+5V-1R
7	BRON-N	8	DCOFF1-P
9	ACOFF-P	10	HRON-N
11	ACSYNC-N	12	SWRUS-P
13	PGND	14	+24
15	PGND	16	+24
17	SGND	18	CN-CHK
19	SGND	20	SGND

⑨

Pin No.	Signal Name	Pin No.	Signal Name
1	SGND(CNT)	2	+5V-2(CNT)
3	SGND(CNT)	4	+5V-2(CNT)
5	SGND(CNT)	6	+5V-2(CNT)
7	SGND(CNT)	8	+5V-2(CNT) or 3.3v-2
9	SGND(CNT)	10	+5V-2(CNT) or 3.3v-2
11	SGND(CNT)	12	+5V-2(CNT) or 3.3v-2
13	SGND(MCTL)	14	+5V-1(MCTL)
15	SGND(MCTL)	16	+5V-1(MCTL)
17	PGND	18	+24V-1D
19	PGND	20	+24V-1D
21	PGND	22	+24V-1D

⑩-1

Pin No.	Signal Name	Pin No.	Signal Name
1	PAI/ODATA0	2	PAI/ODATA1
3	PAI/ODATA2	4	PAI/ODATA3
5	PAI/ODATA4	6	PAI/ODATA5
7	PAI/ODATA6	8	PAI/ODATA7
9	LCDRS	10	LCDE
11	PASWRDN	12	PALEDWRN
13	SGND	14	+5V-1
15	SGND	16	SGND

⑩-2

Pin No.	Signal Name	Panel Side
1	SGND	11
2	VCC(+5V-1)	10
3	VCC(+5V-1)	9
4	RESET	8
5	SGND	7
6	THROTTLE	6
7	SGND	5
8	FP_STS	4
9	SGND	3
10	FP_CMD	2
11	SGND	1

⑪

Pin No.	Signal Name
1	DSL(K)ON-N
2	+24V-1
3	DSL(Y)ON-N
4	+24V-1
5	DSL(M)ON-N
6	+24V-1
7	DSL(C)ON-N
8	+24V-1

⑫

Pin No.	Signal Name
1	PBSEN-N
2	+5V-S
3	SGND

⑬

Pin No.	Signal Name
1	+5V-S
2	PT2-N
3	SGND
4	NC/+5V-S
5	NC/CLROL-N
6	NC/SGND
7	+5V-1
8	PEFULL-N
9	SGND
10	HTFANON-P
11	PGND
12	HTFANERR

⑭

Pin No.	Signal Name	Pin No.	Signal Name
1	NC	2	NC
3	+24V-1D	4	FBCLON-N
5	+24V-1D	6	FUCLON-N
7	+24V-1D	8	TRSLON-N
9	+24V-1D	10	RECLON-N
11	+24V-1D	12	PKCLU1ON-N
13	TBFULL-N	14	SGND
15	WTLEDON	16	SGND
17	+24V-1D	18	DCL(C)ON-N
19	+24V-1D	20	DCL(M)ON-N
21	+24V-1D	22	DCL(Y)ON-N
23	+24V-1D	24	DCL(K)ON-N

⑮

Pin No.	Signal Name	Pin No.	Signal Name
1	DMRDY-N	2	DMON-N
3	DMCLK	4	+24V-1D
5	PGND	6	+24V-1D
7	PGND	8	PGND
9	SGND	10	+5V-1
11	DMGAIN	12	DMOVLD

⑯

Pin No.	Signal Name	Pin No.	Signal Name
1	MMRDY-N	2	MMON-N
3	MMCLK	4	+24-1D
5	PGND	6	+24-1D
7	PGND	8	PGND
9	SGND	10	+5V-1
11	MMENC	12	MMREV-N
13	MMGAIN	14	MMOVLD

⑰

Pin No.	Signal Name	Pin No.	Signal Name
1	PGND	2	+24V-1D
3	PGND	4	+24V-1D
5	PGND	6	+24V-1D
7	PGND	8	+24V-1D
9	SGND	10	+5V-1
11	SGND	12	+5V-1

⑱

Pin No.	Signal Name	Pin No.	Signal Name
1	LFCN-RET	2	+24V-1D
3	PKCLL1ON-N	4	NC/FDCLL1ON-N
5	PSL1	6	PSL2
7	PSL3	8	PSCST1
9	PEL1-P	10	OCST1-N
11	SGND	12	I2C-CLK
13	+5V-S	14	I2C-DATA
15	+5V-1	16	LFCN-CHK-N

⑰

Pin No.	Signal Name	Pin No.	Signal Name
1	TLES(K)-P	2	TLES(Y)-P
3	TLES(M)-P	4	TLES(C)-P
5	TLESCN-N	6	SGND
7	LEDON-P	8	LEDON2-P
9	TLESCHK	10	SGND
11	+24V-1D	12	ELON-N

⑳

Pin No.	Signal Name	Pin No.	Signal Name
1	+5V-S	2	TBEN-N
3	SGND	4	+5V-S
5	PT1-N	6	SGND
7	+5V-S	8	PEU-P
9	SGND	10	+5V-S
11	OHPSENU	12	SGND
13	SGND	14	NC

㉑

Pin No.	Signal Name
1	REARDOPEN-P
2	N_C
3	TOPDOPEN-P

㉒

Pin No.	Signal Name
1	+5V-1
2	PSU1
3	PSU2
4	PSU3
5	PSU4
6	PSU5
7	SGND
8	+5V-S
9	SGND
10	TH3

㉓

Pin No.	Signal Name
1	CTFANON-P
2	PGND
3	CTFANERR

㉔

Pin No.	Signal Name
1	TESTO1
2	TESTO2
3	TESTI1
4	TESTI2

㉕

Pin No.	Signal Name
1	DSW-O:F
2	DSW-I:R

㉖

Pin No.	Signal Name	Pin No.	Signal Name
1	+5V-1	2	CNCHK-RET
3	+5V-1	4	SGND
5	+24V-2	6	SGND
7	+24V-2	8	PGND
9	CN-CHK	10	PGND

㉗ 120V

Pin No.	Signal Name
1	FG
2	P
3	—
4	P2

㉗ 240V

Pin No.	Signal Name
1	FG
2	P
3	P2
4	—

㉘

Pin No.	Signal Name
1	AC IN-N
3	AC IN-L

㉙

Pin No.	Signal Name	Pin No.	Signal Name
1	D-COMMAND	2	DUMBUSY2-N
3	SGND	4	D-STATUS
5	SGND	6	DUPMON-P
7	SGND	8	DUREON-P
9	DUPCHK-N	10	SLEEP
11	+5V-1	12	+5V-1
13	SGND	14	SGND
15	NC	16	NC
1	+24V-2	2G	PGND
3	+24V-2	4G	PGND

㉚

Pin No.	Signal Name	Pin No.	Signal Name
1	+24V-1	2	PKCLL1ON-N
3	PSL1	4	PSL2
5	PSL3	6	PSCST1
7	PEL1-P	8	OCST1-N
9	I2C-DATA	10	I2C-CLK
11	+5V-1	12	SGND
13	+5V-S		

㉛

Pin No.	Signal Name
1	TONEROK-N
2	+5V-S
3	SGND

㉜

Pin No.	Signal Name
1	LDFANON-P
2	PGND
3	LDFANERR

ELECTRICAL COMPONENT LAYOUT (G108)

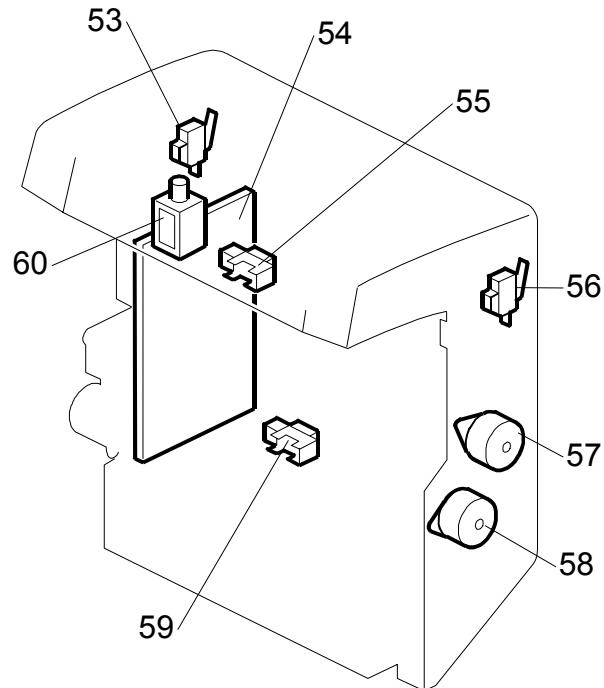
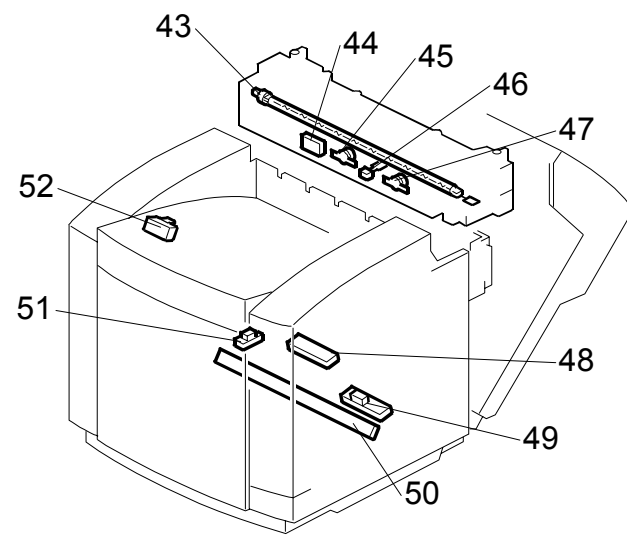
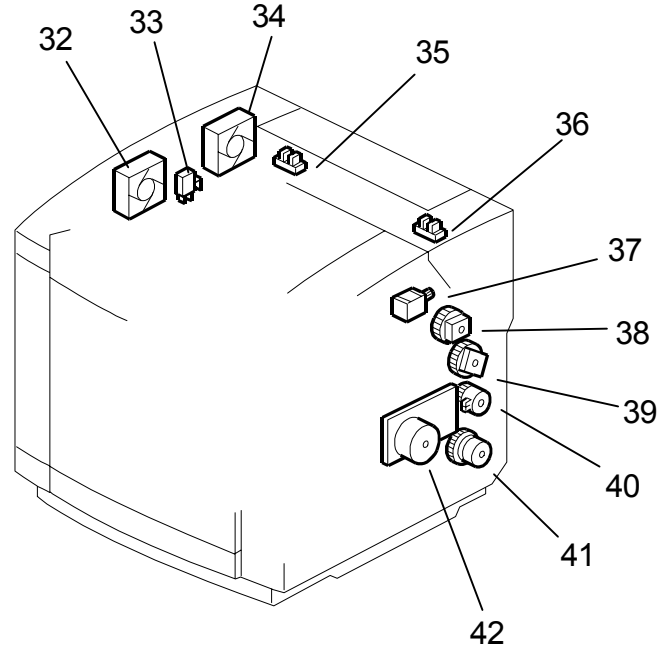
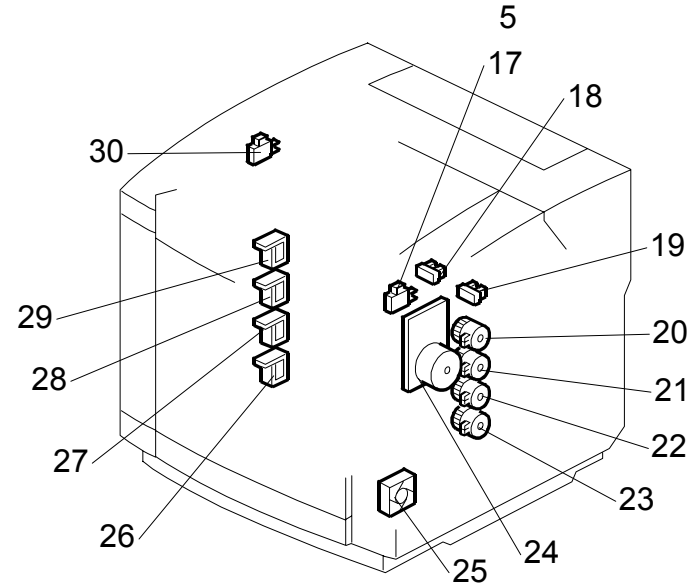
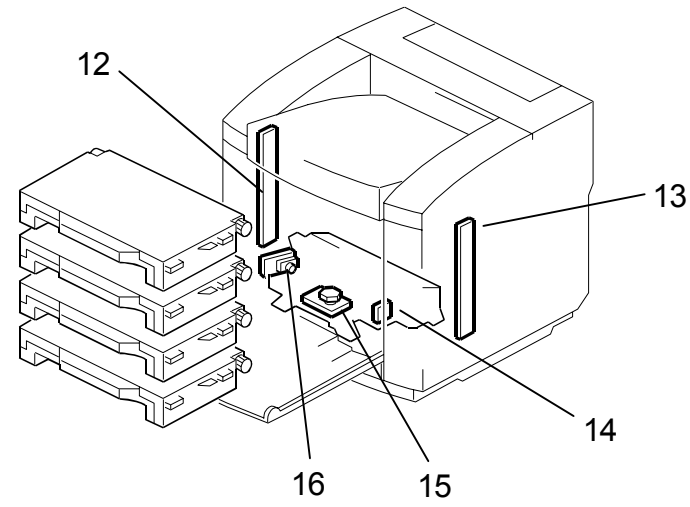
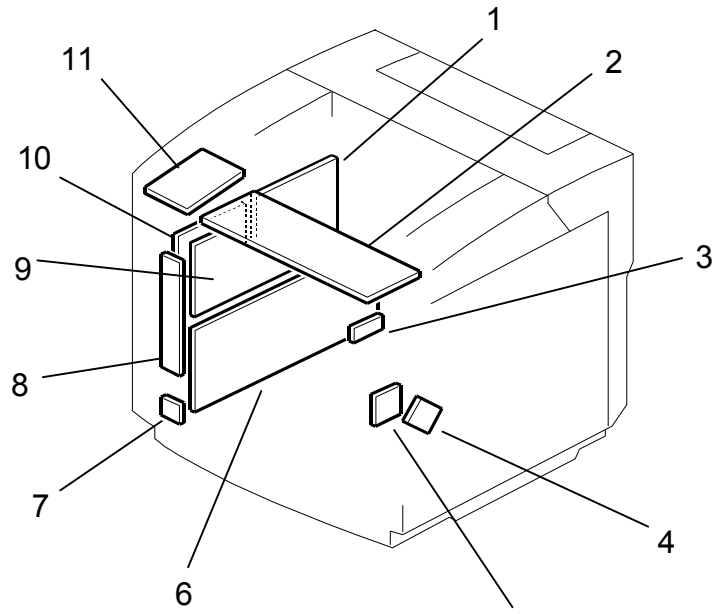

Index		P to P
Lamps		
50	Erase Lamp	B2
43	Fusing Lamp	C2
Magnetic Clutches		
20	Development Clutch K	A7
21	Development Clutch Y	A7
22	Development Clutch M	A7
23	Development Clutch C	A7
41	Paper Feed Clutch	B8
40	Registration Clutch	B8
39	Transfer Clutch	C8
38	Fusing Clutch	C8
62	Paper Feed Clutch (PFU)	A3
Motors		
15	Polygon Mirror Motor	D8
42	Main Motor	A3
24	Development Motor	A4
57	Transport Motor (Duplex Unit)	F7
58	Inverting Motor (Duplex Unit)	F7
PCBs		
11	Operation Panel	E7
1	Controller	D5
10	BCU	D6
9	High Voltage Unit	D3
6	Power Supply Unit	F3
16	LD unit	C8
14	Synchronization Detector	C7
2	I/O Device	B5
44	Temperature Control Board	C2
54	Duplex Unit Controller	F7
Fans		
34	Fusing Fan	B6
32	PSU Fan	C3
25	Optics Unit Fan	A5

Index		P to P
Sensors		
12, 13	Toner End Sensor	A2
8	Development Unit Sensor	C6
49	ID Sensor	E8
51	Transfer Belt Sensor	B3
52	OPC Belt Sensor	B6
3	Paper Size/ Tray Sensor	B4
18	Registration sensor	B3
19	Paper End Sensor	B3
7	Temperature Sensor	B4
4, 5	Waste Toner Sensor	B8
48	OHP Sensor	C3
36	Paper Exit Sensor	B6
35	Paper Overflow Sensor	B6
61	Paper End Sensor (PFU)	A3
63	Paper Size/Tray Sensor (PFU)	A3
55	Paper Sensor 1 (Duplex Unit)	F7
59	Paper Sensor 2 (Duplex Unit)	F7
Solenoids		
37	Cleaning Unit Solenoid	C8
29	Development Solenoid K	C6
28	Development Solenoid Y	C6
27	Development Solenoid M	C6
26	Development Solenoid C	C6
60	Paper Gate Solenoid	F7
Switches		
33	Safety Switch (Rear)	F5
30	Safety Switch (Top)	E5
17	Safety Switch (Front)	F6
53, 56	Safety Switch (Duplex Unit)	F7
Others		
45	Thermostat	B2
47	Thermostat	B2
46	Thermistor	C2

